

MOODY BLUES



Centre point

A freestanding island provides additional work surface but it can also be moved to one side when Isobel needs more space.

It's painted in Farrow & Ball's Hague Blue – a lovely contrast to the light greys used for the rest of the scheme

**PAINTED FURNITURE IN A FREESTANDING FEEL
AND WELL-CHOSEN ACCESSORIES CREATE A HOMELY
KITCHEN FOR ISOBEL THOMPSON'S APARTMENT**

Feature CAROLINE FOSTER *Photography* DAVID PARMITER

‘ISOBEL PARTICULARLY LIKED BLUE TONES SO WE DECIDED TO GO FOR A BRAVE COLOUR SCHEME WITH STRONG ACCENTS’

Rosie Winston, interior designer

The finer details

A selection of modern and vintage accessories add colour to the scheme, balancing out the darker finishes

Project profile

THE OWNER Isobel Thompson, who is a legal analyst

HER HOME A two-bedroom flat in a northwest London mansion house

THE PROJECT The existing layout was altered and dated cabinetry replaced

ROOM SIZE 4 x 4.35m

DESIGNER Rosie Winston of Clifton Interiors in collaboration with Plain English

CABINERY Long House base units and a freestanding island from the Oseo range by Plain English, around £30,000, including installation

BUDGET £40,000



Soft touch

Bespoke leather handles lend a luxurious feel



Timber tops

The beautiful teak worktop adds richness of colour and texture to the scheme



'A CENTRAL ISLAND MAKES FOR A BETTER AND MORE ERGONOMIC DESIGN'

Showing off

A bespoke dresser fits neatly into one alcove, furthering the freestanding feel. It features the same Belgian Fossil stone surface as the island, but it's narrower to match the wooden worktops

Legal analyst Isobel Thompson bought her two-bedroom apartment in a Victorian mansion house in northwest London as a bolthole. Its interior was clean but dated and in need of a complete overhaul. Short on time, Isobel chose to hand the entire refurbishment over to designer Rosie Winston of Clifton Interiors. 'As Isobel spends a great deal of time travelling for work, we met only a handful of times during the process, but communicated regularly by Skype,' says Rosie. 'Architecturally, the flat retained many of its original features, with tall ceilings and large windows, and I wanted to make the most of that,' continues Rosie. The kitchen was very modern, with blocks of wall units that made the room feel closed in, and a kitchen table near the windows, creating a

void in the middle of the room. 'We'd developed an eclectic vintage look for the rest of the apartment and the existing kitchen didn't fit into that style.' Isobel wanted it to feel homely, familiar and practical, with a look that appeared evolved and not contrived. 'I recommended the Long House range from Plain English, which draws inspiration from honest 18th-century English joinery,' says Rosie. 'Isobel also asked for display shelving for her *objets*.' 'In terms of layout, we were a little restricted by the position of the drainage, which couldn't be relocated, and the existing extraction vented out through an old chimney flue,' explains Rosie. 'The concrete ceilings limited our lighting choices, too. But we managed to work around these giving Isobel the smart, hand-crafted design that she liked, which also matched the property's new interior scheme.'

DESIGN SOLUTION *Interior designer Rosie Winston explains...*

How did you come up with the layout?
We had to work with the existing L-shape due to the drainage and extraction constraints, so I introduced a slimline central island, which changed the look of the room enormously. We were fortunate that Isobel didn't need much storage or large appliances, which helped to keep the walls free of units and really opened up the space.

And what were your lighting solutions?
To resolve the issue of the restrictive concrete ceilings, I suggested cable-hung spotlights, which work very well. I was also conscious that the workstation had to have good directional

lighting and a sand-blasted bronze spun pendant plus matching wall lights either side of the range cooker help to visually site the island.

Tell us more about the island
This dainty looking unit is from the Plain English Osea range, which is a slightly different style to the rest of the cabinetry but goes well with the scheme as a whole. The room isn't overly large, so the island had to be small to keep a sense of proportion and not overpower. It also had to be freestanding and mobile so that it can be pushed to the side when Isobel entertains. It gives her more flexibility within the kitchen.

Do you have any basic tips for anyone wanting to create a vintage scheme?
I recommend opting for freestanding furniture in contrasting colours, as we've done in Isobel's home. Certain colours will allude to a particular era. To build on this look, select ceramic brick tiles that are easy to wipe down – think of the sort you'd see on a butcher's wall.

But don't strong colours 'shrink' rooms?
Dark colours recede, so when a room is painted a dark to medium shade, it will actually make the room look larger. It's a great way to add personality, but test a variety of shades before painting large areas.



Leading light

A striking turn-of-the-century pendant lamp adds vintage charm, while illuminating the dining area in dramatic fashion

The layout

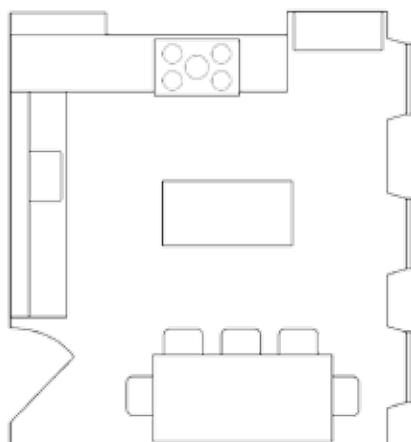

The details

CABINETRY Units from the Long House and Oseo range by Plain English, around £30,000. **Cabinetry paints**, Hague Blue estate eggshell, £51 for 2.5 litres, Farrow & Ball, and Tarlatan oil eggshell, £58 for 2.5 litres, Paint & Paper Library

SURFACES Worktops, 30mm and 50mm Antique Sawn Belgian Fossil stone, from £1,170m; 30mm teak, £966m, all supplied by Plain English. Bespoke timber flooring, £200sq m, Ardern Hodges. Valencia Moonstone wall tiles, £164.47sq m, Fired Earth. **Wall paint**, Stone 1 flat emulsion, £36 for 2.5 litre, Paint & Paper Library. **Woodwork paint**, Railings estate eggshell £51 for 2.5 litres, Farrow & Ball

APPLIANCES Mercury 1000 dual-fuel range cooker in liquorice, £3,100, Carters Direct. Fully integrated fridge, £419; fully integrated freezer, £419, both Liebherr. Fully integrated dishwasher, £1,200, Miele

SINK AND TAP Classic inset 600 ceramic sink, £360, Shaws of Darwen. Steam Valve Original single-lever mixer tap in brushed steel, £478, Hornbeam Ivy

FINISHING TOUCHES Mrs B oak dining table, £820; Vienna beech dining chairs, £160 each, all Benchmark Furniture. Spun pendant light, £258; exterior bracket wall lights, £287 each, all Davey Lighting. Upcycled vintage pendant, price on request, Clifton Interiors